



"Fluid Under Control"



PNEUMATIC ACTUATORS

for ball valves
butterfly valves
plug valves
dampers



UKSEPRO



General Features

- High performance
- High cycle life (1.000.000 operation)
- High torque value
- Standard position indicator
- For quarter turn valve automation (9Nm - 2900Nm)
- One compact design for double and single acting models
- Dual piston rack and pinion
- According to international standards (NAMUR, ISO5211)
- Body: Extruded aluminium
- Piston & Caps: Die cast aluminium
- 90° turn, two external travel stop adjustment $\pm 5\%$
- 100% adjustable travel stop (on request)
- Pressure : Double acting 2.5 bar 8 bar
Single acting 4 bar 8 bar
- Temperature : Standard -20°C 80°C
On request -20°C 150°C, -30°C 80°C
- TORK Pneumatic actuators have been manufactured since 1986
- Lubrication : All moving parts are factory lubricated

Protection levels for TORK actuator



Anodized body



Epoxy coated body



Nickel coated body



100% Adjustable on request



PTFE coated body

Design Features of TORK RA Serie Actuators

1) Actuator Body

Aluminium extruded and honed surface body. Internal and external parts corrosion protected

2) Indicator

It is standard on all actuators, it shows visual position of valve

3) Caps

Provide max. resistance against corrosive elements, same cap design for double and single types actuators

4) Travel Adjustment

Permits adjustment of $\pm 5\%$ in both directions

5) Springs

Springs provide high performance in safe emergency shutdown operation. Cartridge design & corrosion resistant

6) Bearing & Piston guides

High cycle life, wide operation temperature range, lubricating provide high performance

7) Nuts & Bolts

Stainless steel body. Provide long term corrosion resistance.

8) Piston rack and pinion

Provides wear resistance and protect against corrosion. Die cast pistons anodized aluminium fitted with high quality seals and guides.

9) Connections

- Solenoid valves, switch box, positioners : Namur VDI/VDE 3845
- Bottom valve connection: ISO5211, DIN3337 standard

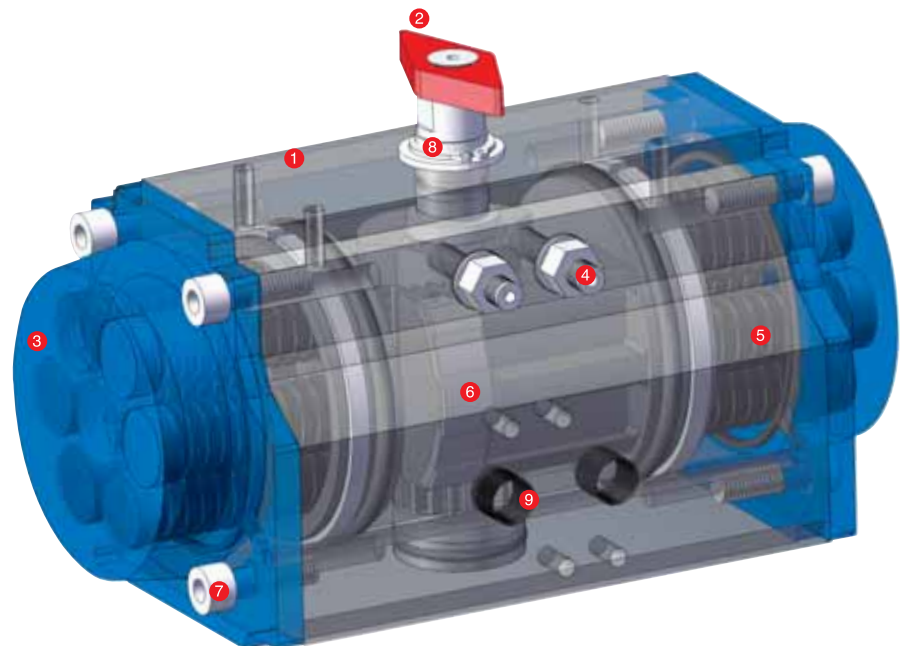

RA ... DA Serie

Double Acting Rotary Pneumatic Actuators

Application	: Ball Valve, Butterfly Valve, Plug Valve, Dampers on-off / proportional control
Size	: RA 32 DA ... RA 400 DA
Supply Pressure Air	: 4 - 8 bar
Output Torque Value	: 9 Nm ... 2900 Nm
Body	: Extruded Aluminium / Cast Aluminium
Caps and Pistons	: Die cast Aluminium
Temperature	: -10 °C...80°C
Valve connection	: ISO 5211 / DIN3337 standard
Limit Switch connection	: Namur standard, VDI / VDE3845
Positioner connection	: Namur standard, VDI / VDE3845
Solenoid Valve connection	: Namur standard, VDI / VDE3845
Stroke Adjustment	: Both directions open and close positions (±5%)
Change to Single Acting	: Add springs



Double Acting Actuator

RA ... SR Serie

Single Acting Rotary Pneumatic Actuators



Single Acting Actuator

Application	: Ball Valve, Butterfly Valve, Plug Valve, Dampers on-off / proportional control
Size	: RA 40 SR ... RA 400 SR
Supply Pressure Air	: 4 - 8 bar
Output Torque Value	: 5 Nm ... 1600 Nm
Body	: Extruded Aluminium / Cast Aluminium
Caps and Pistons	: Die cast Aluminium
Temperature	: -10 °C...80°C
Valve connection	: ISO 5211 / DIN3337 standard
Limit Switch connection	: Namur standard, VDI / VDE3845
Positioner connection	: Namur standard, VDI / VDE3845
Solenoid Valve connection	: Namur standard, VDI / VDE3845
Stroke Adjustment	: Both directions open and close positions (±5%)
Change to Double Acting	: Without springs

RA ... 3P Serie

3 Position Acting Rotary Pneumatic Actuators

Application	: Ball Valve, Butterfly Valve, Plug Valve, Dampers on-off control, filling systems
Size	: RA 40 3P ... RA 120 3P
Supply Pressure Air	: 4 - 8 bar
Output Torque Value	: 18 Nm ... 330 Nm
Body	: Extruded Aluminium
Caps and Pistons	: Die cast Aluminium
Temperature	: -10 °C...80°C
Valve connection	: ISO 5211 / DIN3337 standard
Limit Switch connection	: Namur standard, VDI / VDE3845
Positioner connection	: Namur standard, VDI / VDE3845
Solenoid Valve connection	: Namur standard, VDI / VDE3845
Stroke Adjustment	: Both directions open and close positions (±5%) From caps stroke adjustment: 20°, 30°, 50°, 75°



3 - Position Actuator

RA ... 8D Serie / RA ... 2D

120° and 180° Turn Rotary Pneumatic Actuators



120° and 180° Turn Actuator

Application	: Ball Valve, Butterfly Valve, Plug Valve, Dampers on-off control, filling systems
Size	: RA 40 8D ... RA 120 8D (180° turn) RA 40 2D ... RA 120 2D (120° turn)
Supply Pressure Air	: 4 - 8 bar
Output Torque Value	: 18 Nm ... 330 Nm
Body	: Extruded Aluminium
Caps and Pistons	: Die cast Aluminium
Temperature	: -10 °C...80°C
Valve connection	: ISO 5211 / DIN3337 standard
Limit Switch connection	: Namur standard, VDI / VDE3845
Positioner connection	: Namur standard, VDI / VDE3845
Solenoid Valve connection	: Namur standard, VDI / VDE3845

RA SERIES : SPARE PARTS LIST

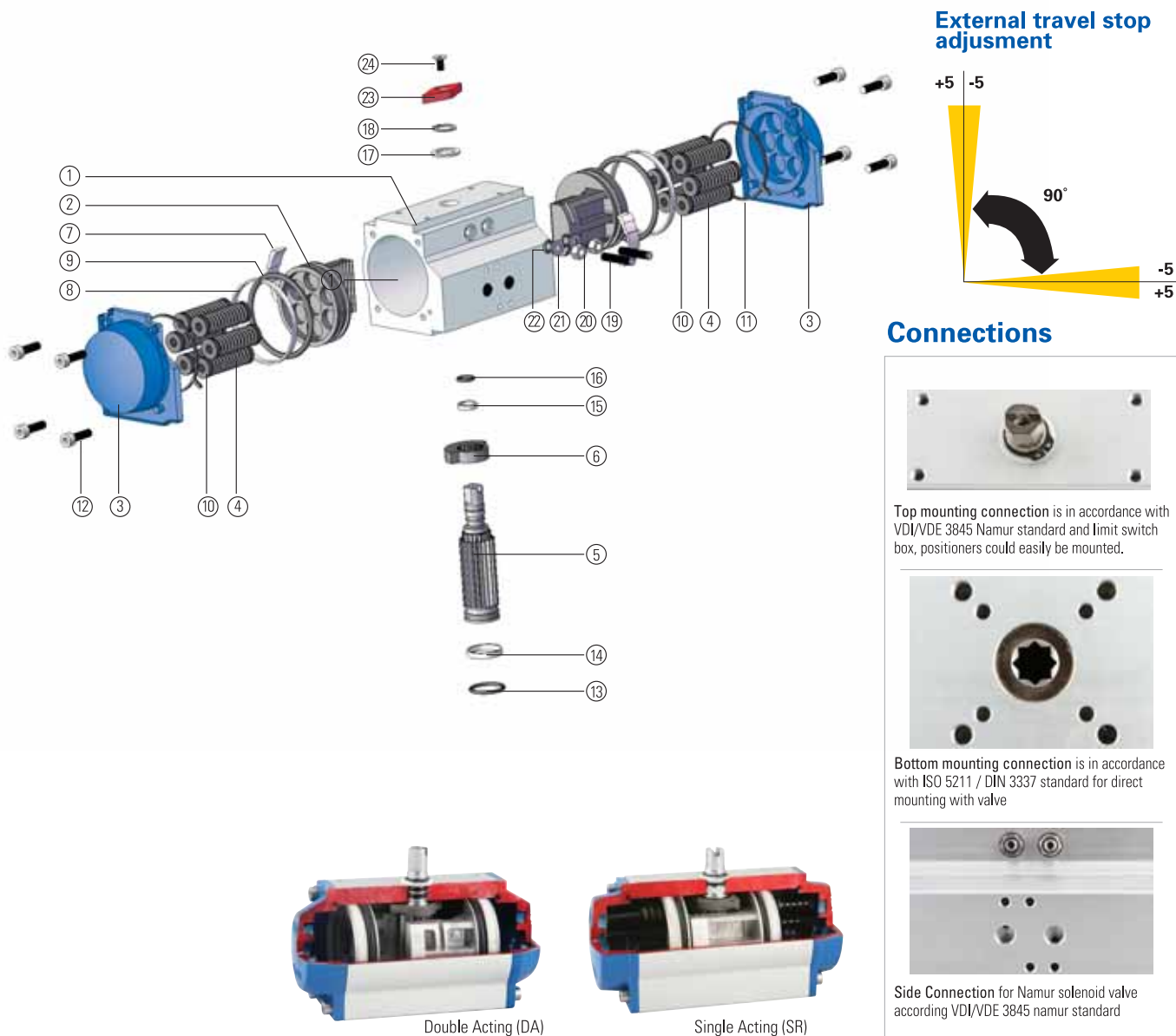

External travel stop adjustment

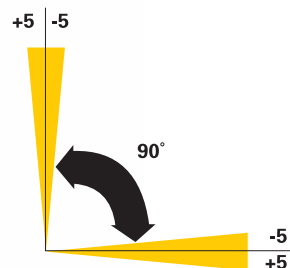

Connections



Top mounting connection is in accordance with VDI/VDE 3845 Namur standard and limit switch box, positioners could easily be mounted.



Bottom mounting connection is in accordance with ISO 5211 / DIN 3337 standard for direct mounting with valve



Side Connection for Namur solenoid valve according VDI/VDE 3845 namur standard

Double Acting (DA)

Single Acting (SR)

PART NO	UNIT / Q'TY	PART DESCRIPTION	STANDARD MATERIAL
1	1	BODY	EXTRUDED ALUMINIUM ALLOY
2	2	PISTON	DIE CAST ALUMINIUM
3	2	CAP	DIE CAST ALUMINIUM
4	min.5/max.12	SPRING	HIGH ALLOY SPING STEEL
5	1	PINION	STEEL ALLOY
6	1	CAM (STOP ARRANGEMENT)	STAINLESS STEEL
7	2	BEARING (PISTON BACK)	POLYPHTALAMIDE
8	2	BEARING (PISTON SLIDING)	POLYPHTALAMIDE
9	2	"O" RING (PISTON)	NITRILE (NBR70)
10	min.5/max.12	SPRING HOLDER	POLYPROPYLENE + GF
11	2	"O" RING (CAP)	NITRILE (NBR70)
12	8	CAP BOLT	STAINLESS STEEL
13	1	"O" RING (PINION BOTTOM)	NITRILE (NBR70)
14	1	BEARING (PINION BOTTOM)	POLYPHTALAMIDE
15	1	BEARING (PINION TOP)	POLYPHTALAMIDE
16	1	"O" RING (PINION TOP)	NITRILE (NBR70)
17	1	THRUST BEARING (PINION)	POLYPHTALAMIDE
18	1	SPRING CLIP (PINION)	STEEL ALLOY
19	2	STOP SET SCREW	STAINLESS STEEL
20	2	STOP NUT	STAINLESS STEEL
21	2	STOP SET SCREW WASHER	STAINLESS STEEL
22	2	"O" RING (STOP SET SCREW)	NITRILE (NBR70)
23	1	INDICATOR	POLYPROPYLENE + GF
24	1	INDICATOR SCREW	STAINLESS STEEL

Torque diagram of TORK Actuators

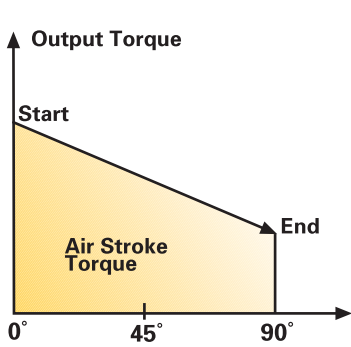

Diagram of TORK Actuator, RA... .SR Serie

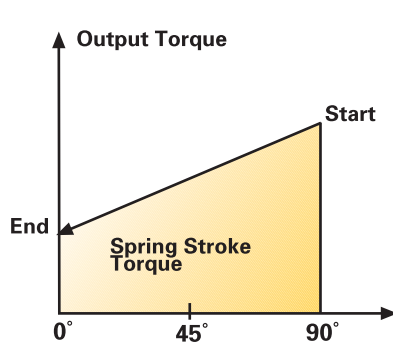
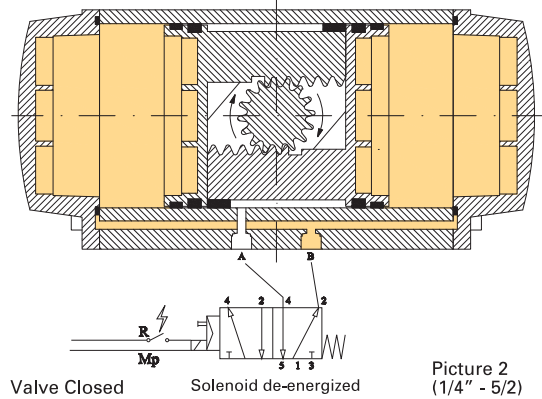
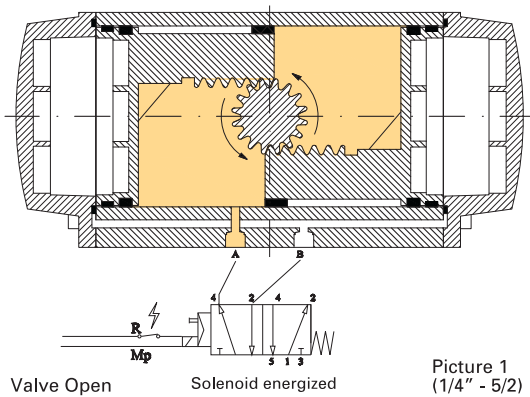
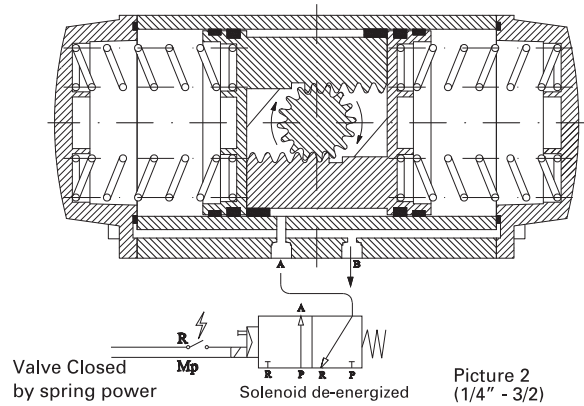
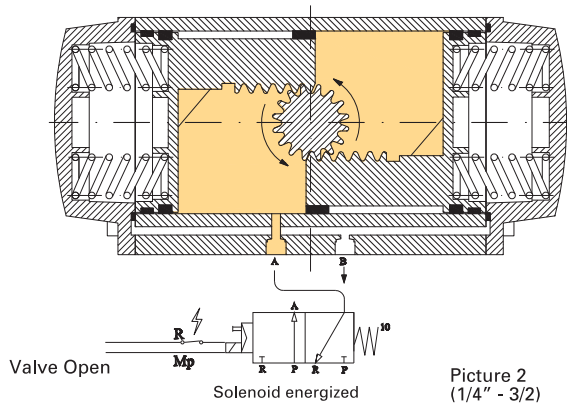

Diagram of TORK Actuator, RA... .DA Serie

Operation of TORK Actuator, RA... .DA Serie



Operation of TORK Actuator, RA... .SR Serie



Spring arrangement of TORK Actuator, RA... .SR Serie

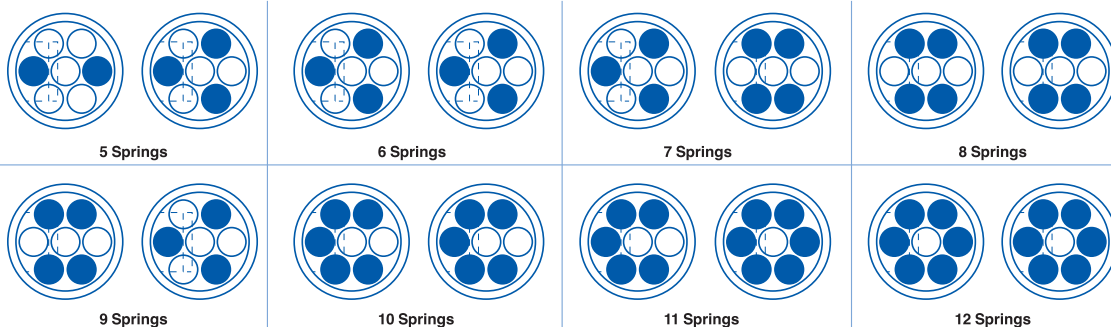

DOUBLE ACTING TORQUE VALUE (According to supplied air pressure range)



RA 32 DA



DOUBLE ACTING TORQUE RATING (Nm)

MODEL	Air Supply Pressure (bar)												
	2.5	3	3.5	4	4.5	5	5.5	6	6.5	7	7.5	8	
RA 32 DA	2.0	3	4.0	5	6.0	7	8.0	9	10.0	11	12.0	13	
RA 40 DA	7.5	9	10.5	12	13.5	15	16.5	18	19.5	21	22.5	24	
RA 60 DA	14	18	22	26	30	34	38	42	46	50	54	58	
RA 80 DA	26	38	50	62	74	86	98	110	122	134	146	158	
RA 100 DA	73	88	103	118	133	148	163	178	193	208	223	238	
RA 120 DA	137.5	165	192.5	220	247.5	275	302.5	330	357.5	385	412.5	440	
RA 143 DA	240	288	336	385	433	480	529	578	626	674	722	770	
RA 160 DA	321	385	450	510	576	642	705	765	833	897	963	1024	
RA 200 DA	628	752	878	1000	1127	1252	1377	1500	1630	1752	1880	2005	
RA 400 DA	1214	1454	1697	1933	2178	2420	2662	2900	3154	3378	3634	3876	

SPRING RETURN TORQUE VALUE (According to supplied air pressure range and springs quantity)



SPRING RETURN TORQUE RATING (Nm)

MODEL	Spring Set	Air Supply Pressure																				Spring Torque							
		2.5 bar		3 bar		3.5 bar		4 bar		4.5 bar		5 bar		5.5 bar		6 bar		6.5 bar		7 bar		7.5 bar		8 bar					
		0° Start	90° End	0° Start	90° End	0° Start	90° End	0° Start	90° End	0° Start	90° End	0° Start	90° End	0° Start	90° End	0° Start	90° End	0° Start	90° End	0° Start	90° End	0° Start	90° End	0° Start	90° End	0°	90°		
RA 40 SR	S05			4.8	2.8	6.3	4.3	7.8	5.8	9.3	7.3	10.8	8.8	12.3	10.3	13.8	11.8	15.3	13.3	16.8	14.8	18.3	16.3	19.8	17.8	4.2	6.3		
	S06					5.5	3.0	7.0	4.5	8.5	6.0	10.0	7.5	11.5	9.0	13.0	10.5	14.5	12.0	16.0	13.5	17.5	15.0	19.0	16.5	5.0	7.5		
	S07							6.2	3.3	7.7	4.8		9.2	6.3	10.7	7.8	12.2	9.3	13.7	10.8	15.2	12.3	16.7	13.8	18.2	15.3	5.8	8.8	
	S08												8.3	5.0	9.8	6.5	11.3	8.0	12.8	9.5	14.3	11.0	15.8	12.5	17.3	14.0	6.7	10.0	
	S09														9.0	5.3	10.5	6.8	12.0	8.3	13.5	9.8	15.0	11.3	16.5	12.8	7.5	11.3	
	S10																9.7	5.5	11.2	7.0	12.7	8.5	14.2	10.0	15.7	11.5	8.3	12.5	
	S11																		10.3	5.8	11.8	7.3	13.3	8.8	14.8	10.3	9.2	13.8	
	S12																			11.0	6.0	12.5	7.5	14.0	9.0	10.0	15.0		
	RA 60 SR	S05			10.5	3.8	14.5	7.8	18.5	11.8	22.5	15.8	26.5	19.8	30.5	23.8	34.5	27.8	38.5	31.8	42.5	35.8	46.5	39.8	50.5	43.8	7.5	14.2	
		S06					13.0	5.0	17.0	9.0	21.0	13.0	25.0	17.0	29.0	21.0	33.0	25.0	37.0	29.0	41.0	33.0	45.0	37.0	49.0	41.0	9.0	17.0	
		S07							15.5	6.2	19.5	10.2	23.5	14.2	27.5	18.2	31.5	22.2	35.5	26.2	39.5	30.2	43.5	34.2	47.5	38.2	10.5	19.8	
		S08							14.0	3.3	18.0	7.3	22.0	11.3	26.0	15.3	30.0	19.3	34.0	23.3	38.0	27.3	42.0	31.3	46.0	35.3	12.0	22.7	
S09											16.5	4.5	20.5	8.5	24.5	12.5	28.5	16.5	32.5	20.5	36.5	24.5	40.5	28.5	44.5	32.5	13.5	25.5	
S10													19.0	5.7	23.0	9.7	27.0	13.7	31.0	21.7	35.0	21.7	39.0	25.7	43.0	29.7	15.0	28.3	
S11															21.5	6.8	25.5	10.8	29.5	14.8	33.5	18.8	37.5	22.8	41.5	26.8	16.5	31.2	
S12																	24.0	8.0	28.0	12.0	32.0	16.0	36.0	20.0	40.0	24.0	18.0	34.0	
RA 80 SR		S05			13.0	-2.0	25.0	10.0	37.0	22.0	49.0	34.0	61.0	46.0	73.0	58.0	85.0	70.0	97.0	82.0	109.0	94.0	121.0	106.0	133.0	118.0	25.0	40.0	
		S06					20.0	2.0	32.0	14.0	44.0	26.0	56.0	38.0	68.0	50.0	80.0	62.0	92.0	74.0	104.0	86.0	116.0	98.0	128.0	110.0	30.0	48.0	
		S07					15.0	-6.0	27.0	6.0	39.0	18.0	51.0	30.0	63.0	42.0	75.0	54.0	87.0	66.0	99.0	78.0	111.0	90.0	123.0	102.0	35.0	56.0	
		S08							22.0	-2.0	34.0	10.0	46.0	22.0	58.0	34.0	70.0	46.0	82.0	58.0	94.0	70.0	106.0	82.0	118.0	94.0	40.0	64.0	
	S09									29.0	2.0	41.0	14.0	53.0	26.0	65.0	38.0	77.0	50.0	89.0	62.0	101.0	74.0	113.0	86.0	45.0	72.0		
	S10											36.0	6.0	48.0	18.0	60.0	30.0	72.0	42.0	84.0	54.0	96.0	66.0	108.0	78.0	50.0	80.0		
	S11													43.0	10.0	55.0	22.0	67.0	34.0	79.0	46.0	91.0	58.0	103.0	70.0	55.0	88.0		
	S12																50.0	14.0	62.0	26.0	74.0	38.0	86.0	50.0	98.0	62.0	60.0	96.0	
	RA 100 SR	S05	42.2	21.3	57.2	36.3	72.2	51.3	87.2	66.3	102.2	81.3	117.2	96.3	132.2	111.3	147.2	126.3	162.2	141.3	177.2	156.3	192.2	171.3	207.2	186.3	30.8	51.7	
		S06			51.0	26.0	66.0	41.0	81.0	56.0	96.0	71.0	111.0	86.0	126.0	101.0	141.0	116.0	156.0	131.0	171.0	146.0	186.0	161.0	201.0	176.0	40.0	62.0	
		S07					58.8	30.7	74.8	45.7	89.8	60.7	104.8	75.7	119.8	90.7	134.8	105.7	149.8	120.7	164.8	135.7	179.8	150.7	193.8	165.7	43.2	72.3	
		S08							68.7	35.3	83.7	50.3	98.7	65.3	113.7	80.3	128.7	95.3	143.7	110.3	158.7	125.3	173.7	140.3	188.7	155.3	49.3	82.7	
S09											77.5	40.0	92.5	55.0	107.5	70.0	122.5	85.0	137.5	100.0	152.5	115.0	167.5	130.0	182.5	145.0	55.5	93.0	
S10													86.3	44.7	101.3	59.7	116.3	74.7	131.3	89.7	146.3	104.7	161.3	119.7	176.3	134.7	61.7	103.3	
S11															95.2	49.3	110.2	64.3	125.2	79.3	140.2	94.3	155.2	109.3	170.2	124.3	67.8	113.7	
S12																	104.0	54.0	119.0	69.0	134.0	84.0	149.0	99.0	164.0	114.0	74.0	124.0	
RA 120 SR		S05	84.2	45.8	111.7	73.3	139.2	100.8	166.7	128.3	194.2	155.8	221.7	183.3	249.2	210.8	276.7	238.3	304.2	265.8	331.7	293.3	359.2	320.8	386.7	348.3	53.3	91.7	
		S06			101.0	55.0	128.5	82.5	156.0	110.0	183.5	137.5	211.0	165.0	238.5	192.5	266.0	220.0	293.5	247.5	321.0	275.0	348.5	302.5	376.0	330.0	64.0	110.0	
		S07					117.8	64.2	145.3	91.7	172.8	119.2	200.3	146.7	227.8	174.2	253.3	201.7	282.8	229.2	310.3	256.7	337.8	284.2	365.3	311.7	74.7	128.3	
		S08							134.7	73.3	162.2	100.8	189.7	128.3	217.2	155.8	244.7	183.3	272.2	210.8	299.7	238.3	327.2	265.8	354.7	293.3	85.3	146.7	
	S09										151.5	82.5	179.0	110.0	206.5	137.5	234.0	165.0	261.5	192.5	289.0	220.0	316.5	247.5	344.0	275.0	96.0	165.0	
	S10												168.3	91.7	195.8	119.2	223.3	146.7	250.8	174.2	278.3	201.7	305.8	229.2	333.3	256.7	106.7	183.3	
	S11														185.2	100.8	212.7	128.3	240.2	155.8	267.7	183.3	295.2	210.8	322.7	238.3	117.3	201.7	
	S12																	202.0	110.0	229.5	137.5	257.0	165.0	284.5	192.5	312.0	220.0	128.0	220.0
	RA 143 SR	S02						169.5	37.3	217.5	85.3	264.5	132.3	313.5	181.3	362.5	230.3	410.5	278.3	458.5	326.3	506.5	374.3	554.5	422.3	215.5	347.7		
	RA 160 SR	S02						226.7	50.7	292.7	116.7	358.7	182.7	421.7	245.7	481.7	305.7	549.7	373.7	613.7	437.7	679.7	503.7	740.7	564.7	283.3	459.3		
	RA 200 SR	S02						336.7	107.8	463.7	234.8	588.7	359.8	713.7	484.8	836.7	607.8	966.7	737.8	1088.7	859.8	1216.7	987.8	1341.7	1112.8	663.3	892.2		
	RA 400 SR	S02						682.7	251.3	927.7	496.3	1169.7	738.3	1411.7	980.3	1649.7	1218.3	1903.7	1472.3	2127.7	1696.3	2383.7	1952.3	2625.7	2194.3	1250.3	1681.7		

Note: The yellow pointed values above are the output torque of actuator. Please pay attention to these values while choosing valve for actuator.

*For Actuator 0° : Start : Closed position actuator, 90° : End : Open position actuator

**For Spring 0° : Spring mounting position, 90° : Spring pressed by pistons

*1 bar: 14.5 PSI 1 Nm: 8.85 Lb-in 1 Kgm: 9.81 Nm

DIMENSION OF TORK ACTUATORS

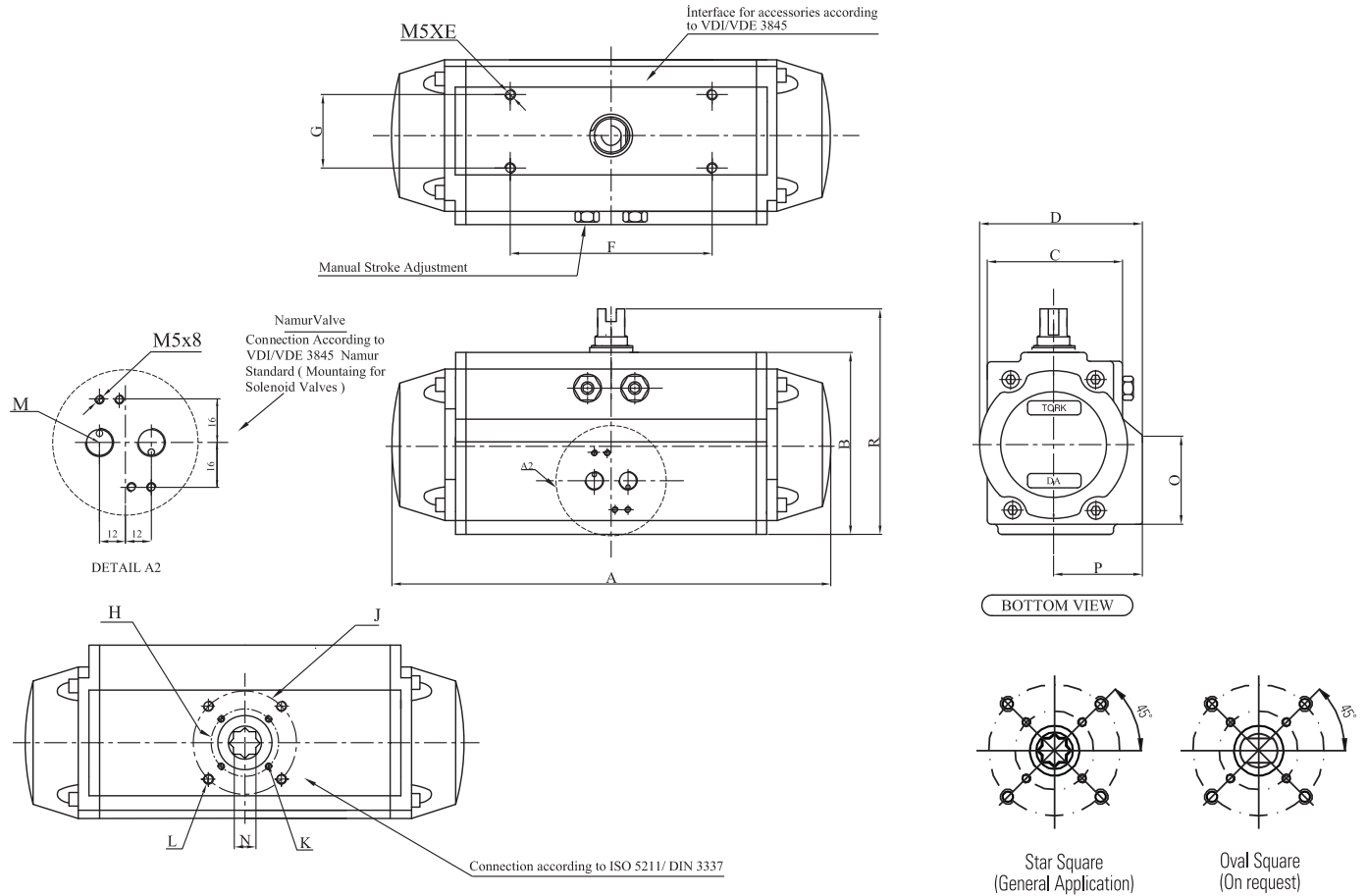

DIMENSION (mm)

ACTUATOR MODELS	A	B	C	D	E	F	G	H	J	K	L	M	N	O	P	R	ISO Flange for H	ISO Flange for J
RA 32 DA	98	45	46	-	8.0	50	25	36	-	M5	-	1/8"	9	-	-	66	F03	-
RA 40 DA/SR	137.2	70.0	52.0	70.6	8.0	80.0	30.0	36/42/50	-	M5	M6	1/8"	9/11	45.0	39.7	90.0	F03/F04	F05
RA 60 DA/SR	172.6	85.2	62.0	82.7	8.0	80.0	30.0	42/50	70.0	M5/M6	M8	1/8"	9/11/14	47.0	47.0	105.2	F04/F05	F07
RA 80 DA/SR	242.0	116.9	91.8	109.2	8.0	80.0	30.0	50	70.0	M6	M8	1/8"	14	54.8	58.3	136.9	F05	F07
RA 100 DA/SR	282.0	130.0	95.0	121.0	8.0	80.0	30.0	70	102.0	M8	M10	1/4"	17	61.0	65.0	160.0	F07	F10
RA 120 DA	360.0	160.0	116.2	150.0	8.0	80.0	30.0	70	102.0	M8	M10	1/4"	17/22	82.0	87.2	190.0	F07	F10
RA 143 DA	342	190	182	182	8.0	80.0	30.0	102	140	M10	M16	1/4"	22/27	91	91	210	F10	F14
RA 160 DA	374	216	202	202	8.0	80.0	30.0	102	140	M10	M16	1/4"	22/27	101	101	236	F10	F14
RA 200 DA	458	268	242	242	8.0	80.0	30.0	-	140/165	-	M20	1/4"	36	121	121	288	-	F14/F16
RA 400 SR	458	595	245	245	8.0	80.0	30.0	-	140/165	-	M20	1/4"	36	123	123	615	-	F14/F16
RA 143 SR	514	190	182	182	8.0	80.0	30.0	102	140	M10	M16	1/4"	22/27	91	91	210	F10	F14
RA 160 SR	558	216	202	202	8.0	80.0	30.0	102	140	M10	M16	1/4"	22/27	101	101	236	F10	F14
RA 200 SR	680	268	242	242	8.0	80.0	30.0	-	140/165	M16	M20	1/4"	36	121	121	288	-	F14/F16
RA 400 SR	680	595	245	245	8.0	80.0	30.0	-	140/165	M16	M20	1/4"	36	123	123	615	-	F14/F16

ACTUATOR MODELS	Air Volume Opening (L)	Air Volume Closing (L)	Opening Time (Sec.)	Closing Time (Sec.)	Approximate weight (kg)
RA 32 DA	DA	0.03	0.02	0.1	0.4
RA 40 DA/SR	DA	0.09	0.16	0.22	0.85
	SR			0.26	1.02
RA 60 DA/SR	DA	0.17	0.28	0.27	1.70
	SR			0.33	1.80
RA 80 DA/SR	DA	0.50	0.79	0.39	3.80
	SR			0.48	4.40
RA 100 DA/SR	DA	0.73	1.15	0.52	4.90
	SR			0.63	6.10
RA 120 DA/SR	DA	1.61	2.45	0.95	9.60
	SR			1.15	11.40
RA 143 DA	DA	2.85	1.95	2.40	13.00
RA 160 DA	DA	3.25	2.56	2.60	19.10
RA 200 DA	DA	6.41	5.50	3.40	33.40
RA 400 DA	DA	12.60	10.80	4.30	72.00
RA 143 SR	SR	2.85	4.70	3.20	17.60
RA 160 SR	SR	3.25	5.36	3.80	26.80
RA 200 SR	SR	6.41	10.50	4.80	45.90
RA 400 SR	SR	12.60	20.79	5.90	98.00



Principle of operation for 3-Position actuators:

3 position actuators are used in filling systems. (Ball or butterfly valves)
 1st. operation: actuator turns 90° and valve open 100% (5/2 way solenoid)
 2nd. operation: Actuator is closed (0-45°) on chosen value. (Value changable with stroke screws) (3/2 way solenoid)
 3rd. operation: Actuator is closed and the valve is 100% closed. (Both solenoid valves are de-energized)

Special version :

- 180° actuators (half turn rather than quarter turn)
- 3-position actuators for 3 way valves.
- Actuator with hydraulic speed control, for very slow operating speed.

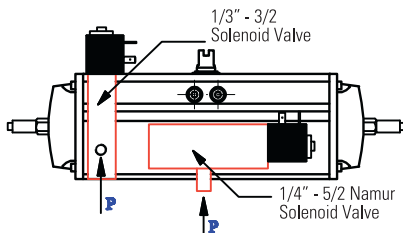

Controlled by two solenoid valves (1/4\"/>

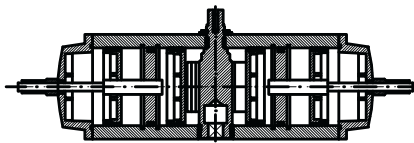

BOTTOM VIEW

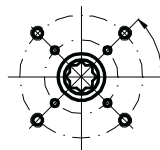

Star Square (General Application)



Application

APPLICATION

- Generally used in filling systems
- With Ball Valves
- With Butterfly Valves

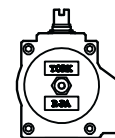
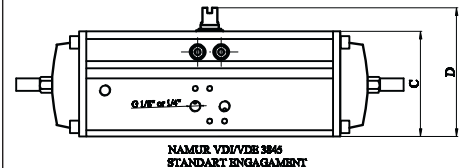

NAMUR VDI/VDE 3845 NAMUR STANDARD

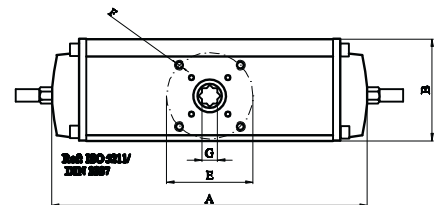
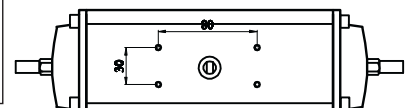

3-Position Actuator types, dimension and output torques

Type Order Number	P: 6 bar Torque Nm	Dimension (mm)									ISO 5211 Flange	Operating time (sec.)		Air consumption (lt.)		Weight (kg)
		A	B	C	D	EØ	F	G	J	H		Opening	Closing	Open	Close	
RA 40.3P	18	238	64	70	90	36/42	m5x8	9	-	-	F03 / F04	0.2	0.2	68	42	1.3
RA 60.3P	42	294	88	90	110	42/50	m5xm6	9/11	m8	70	F04 / F05 / F07	0.5	0.45	182	144	3
RA 80.3P	110	346	104	116	136	50	m6	14	m8	70	F05 / F07	1.1	1	410	310	5.2
RA 100.3P	178															
RA 120.3P	330															



5/2 way



3/2 way



5/2 way



5/2 way (Exproof/Atex)



5/2 way



Panel mounting

APPLICATION

- Pneumatic Rotary actuator
- 5/2 way for Double Acting actuator
- 3/2 way for Single Acting actuator

Namur Solenoid Valve Type

Type Order Number	Valve Position, Way, Namur standard	Standard Coil (IP 65)	On request Ex-proof Coil (EExmd II.T4)	Coil Voltage	Manuel Lock	Weight (g)
T-NM52.W1S	1/4" - 5/2 Single coil	C20		220 V AC	Standard	0.25
T-NM52.W2S	1/4" - 5/2 Double coil			110 V AC		
T-NM32.W1S	1/4" - 3/2 Single coil			24 V AC		
T-ExNM52.W1S	1/4" - 5/2 Single coil	C21		12 V AC		0.3
T-ExNM52.W2S	1/4" - 5/2 Double coil			24 V DC		0.25
T-ExNM32.W1S	1/4" - 3/2 Single coil			12 V DC		

Specify coil type and voltage with order Protection class: IP 65 (Standard), ATEX Ex: EExmd II T4 (On request). For other types solenoid valves; contact us.

MOUNTING KITS

Mounting kits are used to connect actuators with valves (if valve isn't according to ISO 5211 standard, it needs a mounting kit.)

- 1- Brackets: Cast aluminium body epoxy coated
- 2- Brackets: Steel / stainless steel body
- 3- Coupling: Steel / stainless steel body



Parts of mounting kits

FILTER REGULATOR

Filter + regulator + lubricator

Type	Features	Size
FR+LM142008RPESA	Automatic drain	1/4"
FR+CM122008RPESA	Automatic drain	1/2"
T-FR100	Automatic drain	1/4"



Type	Features	Size
MRR1812R	Micro regulator	1/8"
MRR1412R	Micro regulator	1/4"
RG93	High accuracy regulator	1/4"





LS10

- On-off valve position indicator
- Compact, small body
- Protection class: IP 67 waterproof
- Small body, Aluminium die cast
- Bolts on visual position indicator
- Body is composed of Aluminium die cast and powder coating
- Dual cable entries: NPT
- Easy mounting bracket Namur standard, stainless steel shaft and bracket
- LS30.2M exproof



LSV70



LS30

LS80



Application
(Proximity Limit Switch Box)

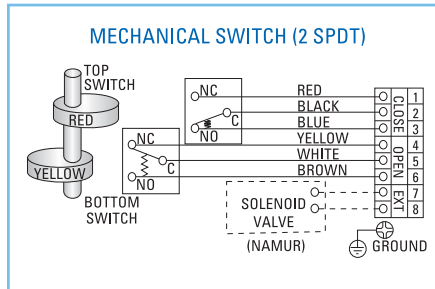

APPLICATION

- Pneumatic rotary actuator
- Actuated ball valves and butterfly valves
- Dampers
- Position of actuated valve is shown by switch box indicator

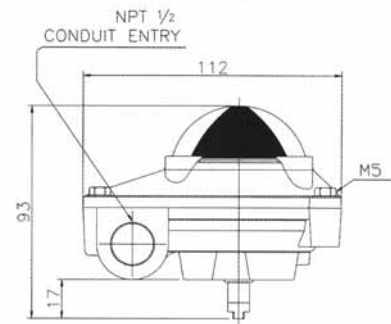
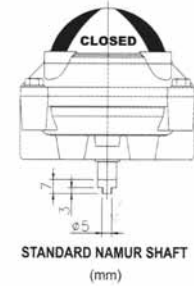

LS10

Application
(LS10, limit switch box)

Limit Switch Box Types for Order

Type Order Number	Features	Position Indicator	Bracket	Body	Weight (kg)
LS10.2M	2 pcs. mechanical limit switch 250 V AC / 3A, IP 67	Closed : Red Open: Yellow	Stainless Steel Namur Standard	Aluminium die cast -20 ÷ 80°C	1
LS10.2P	2 pcs. proximity switches 2 pcs. cable entries holes				1
LS30.2M	2 pcs. mechanical limit switch 250 V AC / 3A, IP 67 E EXd IICT6, E EXia IICT6, IP 67, IP 68 (Option)				1.75
LS30.2P	2 pcs. proximity switches 2 pcs. cable entries holes E EXd IICT6, E EXia IICT6, IP 67, IP 68 (Option)				1.75
LS80.2P	Magnetic Switch box, 2 pcs. proximity switches 1 pcs. cable entries holes				
LS70.2M	with pneumatic namur valve switch box, IP 67 2 pcs. mechanical limit switch E EXd IIBT6				

M: Mechanical limit switch P: Proximity limit switch



> Input signal : 4-20mA; 24 V DC

T-EP.R
Electro Pneumatic
Rotary Type Positioner

APPLICATION

• Positioners are used on pneumatic actuated valves for proportional control

- For Rotary Actuator, easy maintenance
- Simple SPAN and Zero adjustments, precise calibration
- Simple conversion to direct acting, reverse acting
- Air Consumption: 5 LPM (sup. 1.4 kg/cm³)
- Linearity : With in $\pm 1.5\%$ F.S (Full scale)
- Sensitivity : With in $\pm 0.5\%$ F.S (Full scale)
- Repeatability : With in $\pm 0.5\%$ F.S (Full scale)
- Body Material: Aluminium Die cast corrosion-resistant coating
- Protection Class : IP 66 weatherproof
Options: Flame proof Exmd II B T5, ATEX Exmd II C T5
- Intrinsic safety (Exia II B T6)
- Position Feedback (optional) : Position transmitter 4-20 mA output signal (only for weatherproof) Two SPDT Limit switches
- Certified for EMC (Kn046 / E04) in conformance with EN 6100 6.2.2 by RNTUV

> Input signal: 3 - 15 psi (0.2 - 1.0 bar)

T-PP.R
Pneumatic Pneumatic
Rotary Type Positioner



T-SS2R Smart Positioner
HART Communication



T-EPR Electromechanic
Positioner (Rotary)
T-EPL Electromechanic
Positioner (Linear)

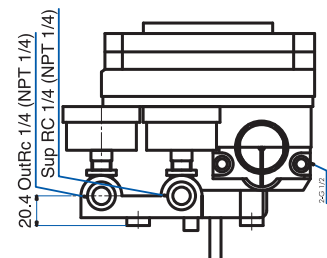
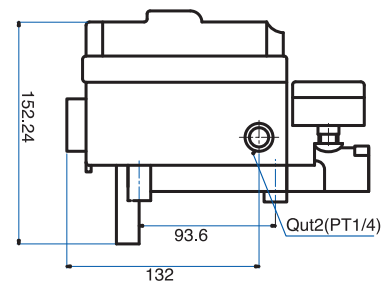
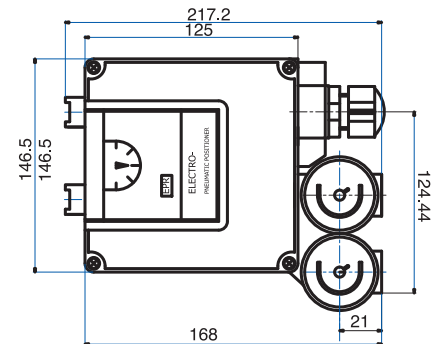

Electro-Pneumatic Positioner

Type Order Number	Input Signal and Air Supply	Protection Class	Bracket	Body	Air Consumption	Weight
T-EPR	mA / bar	I/P 66	Namur		Kgf/Cm³	(kg)
T-EP.R Rotary	4-20 mA / max. 7 bar	I/P 66	80x30	Aluminium die cast	5LPM (1.4)Kgf/cm ³	2.9
T-EP.L Linear	4-20 mA / max. 7 bar	I/P 66	80x30	Aluminium die cast	5LPM (1.4)Kgf/cm ³	2.9
T-SS.2R Rotary	4-20 mA / max. 7 bar	I/P 66	80x30	Aluminium die cast	0.04 Kg/h	2.5
T-SS.2L Linear	4-20 mA / max. 7 bar	I/P 66	80x30	Aluminium die cast	0.04 Kg/h	2.5

Pneumatic -Pneumatic Positioner

Type Order Number	Input Signal and Air Supply	Repeatability	Bracket	Body	Air Consumption	Weight
T-EPR	mA / bar	%F.S	Namur		Kgf/Cm³	(kg)
T-PP.R Rotary	3-15 psi / max. 7 bar	With in $\pm 05\%$ F.S	80x30	Aluminium die cast	5LPM (1.4)Kgf/cm ³	2.1
T-PP.L Linear	3-15 psi / max. 7 bar	With in $\pm 05\%$ F.S	80x30	Aluminium die cast	5LPM (1.4)Kgf/cm ³	2.1



APPLICATION

• T-MOR Series gear operators offer a simple and reliable method of local manual operation, as emergency control on air failure or as a local control in the event of controller malfunction. As such, when the hand wheel is clutched in, the valve is under local manual control and remote control is "locked out".

Type Order Number	Torque Value	Body	Ambient Temp.	Weight
T-MOR	Nm		°C	(kg)
T-MOR 100	100	Cast iron	-20/80	1.5
T-MOR 450	450			4.4
T-MOR 750	750			10.2
T-MOR 1500	1500			36
T-MOR 3500	3500			38

ELECTRO PNEUMATIC TRANSDUCERS

- Small size, light weight
- Low air consumption
- Mounts at any angle
- Low supply pressure sensitivity
- Low cost
- CE approval

The type T-1000 transducer is a electro-pneumatic device that reduces a supply pressure to a regulated output pressure directly proportional to an electrical input signal.

T-1000 accepts a wide range of supply pressure valve ranging from a minimum of 3 psi (0.2 bar) above the maximum output up to 100 psi (6.9 bar)

Transducer I/P and E/P

Type Order Number	Input signal	Output Signal	Air Supply	Linearity	Supply Pressure Sensitivity	Hysteresis	Air Consumption	Weight
T-1000	mA / V	psi	bar				kgf/cm³	(kg)
T-1000 I/P	4-20 mA	3-15 psi	7	<1.0 %	± 0.15% of Span per 1.5 bar	<1% of span	<1% of span	0.75
T-1000 E/P	0-5V							0.75



4 - 20

POSITION TRANSMITTER

- Power supply range : 12 V ... 30 V DC
- Output Signal : 4-20 mA
- Span : Adjustable from 10° ... 100° of angular rotation
- Null : 4 mA position may be set at any angular rotation
- Repeatability : ± 0.25 % F.S [(Full scale)]
- Linearity : ± 1.0 % F.S
- Hysteresis : 1.0 % F.S
- Explosion proof : Exd II B T6 (on request)

- Protection : IP 66 (Standard)
- Operating temperature : -20°C ... 70°C
- Conduit connection : 2.G 1/2 or NPT 1/2
- Measuring position feedback
- Note that the input signal should be provided for measurement of output signal.
 - 1- With a mA loop calibrator select measurement mode and connect + and -
 - 2- With a multimeter tester (mA)

APPLICATION

• T-PT.R rotary types are the 2-wire devices that generate 4-20 mA output signal with position feedback from the control valve.

Type Order Number	Output Signal	Power Supply	Repeatability	Body	Protection	Weight
T-PT.R	mA		F.S.			(kg)
T-PT.R Rotary	4-20 mA	12 ... 30 V DC	0.25% F.S.	Aluminium die cast	IP 66	2.3



Actuated Ball Valves, 2/2 and 3/2 Way, AISI 316 Body

Application : Liquid, gas, air, water, hot water, steam
On Request : Limit switch box, positioner, Namur solenoid valve, manual override
Type No : PAV 903.DA, PAV 903.SR, PAV 904.DA, PAV 904.SR
Actuator : RA..DA / SR rotary pneumatic actuator Double / Single
Supply Air : 4-6 bar. Stroke adjustment
Ball Valve : Body: AISI 316 Stainless steel, 2/2 or 3/2 way, screwed connection and ISO5211 standard actuator
Pressure : PN40,PN16
Temperature : -30...180°C
Size : 1/2" ... 2"

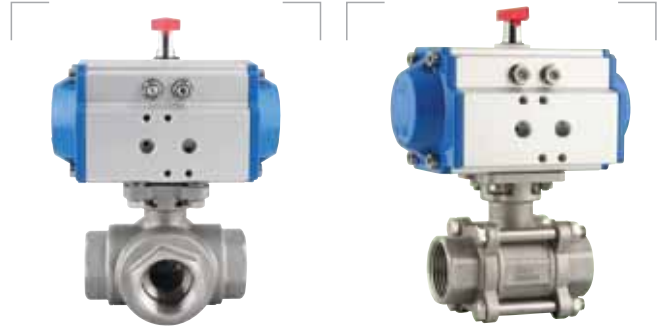

PAV 904 DA (Double Acting)
PAV 904 SR (Single Acting)

PAV 903 DA (Double Acting)
PAV 903 SR (Single Acting)

Actuated Ball Valves, 2/2 and 3/2 Way, Brass Body



PAV 901 DA (Double Acting)
PAV 901 SR (Single Acting)

PAV 902 DA (Double Acting)
PAV 902 SR (Single Acting)

Application : Liquid, gas, air, water, hot water, steam
On Request : Limit switch box, positioner, namur solenoid valve, manual override
Type No : PAV 901.DA, PAV 901.SR, 2/2 way PAV 902.DA, PAV 902.SR, 3/2 way
Actuator : RA..DA/SR rotary pneumatic actuator Double / Single
Supply Air : 4-6 bar. Stroke adjustment
Ball Valve : Body: Brass, 2/2 or 3/2 way, screwed connection and ISO5211 standard actuator
Pressure : PN40,PN16
Temperature : -30...130°C
Size : 1/2" ... 2"

Actuated Ball Valves, 2/2 and 3/2 Way, Flanged Connection, Stainless Steel

Application : Liquid, gas, air, water, hot water, steam
On Request : Limit switch box, positioner, namur solenoid valve, manual override
Type No : PAV 905.DA, PAV 905.SR
Actuator : RA..DA/SR rotary pneumatic actuator Double / Single
Supply Air : 4-6 bar. Stroke adjustment
Ball Valve : Body: AISI 316 and Cast iron, 2/2 or 3/2 way, flanged connection and ISO5211 standard actuator
Pressure : PN40,PN16
Temperature : -30..180°C
Size : NW15 ... NW200 Flange



PAV 905 DA / PAV 905 SR

Actuated Naturalgas Ball Valves and Plug Valves, 2/2 Way, Flanged Connection

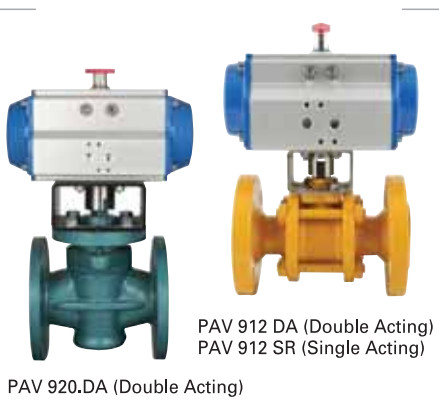

PAV 920.DA (Double Acting)

PAV 912 DA (Double Acting)
PAV 912 SR (Single Acting)

Application : Liquid, gas, air, water, hot water, steam
Natural gas, LPG Gas
On Request : Limit switch box, positioner, namur solenoid valve, manual override
Type No : PAV 920.DA, PAV 920.SR PAV 912.DA, PAV 912.SR
Actuator : RA..DA/SR rotary pneumatic actuator Double / Single
Supply Air : 4-6 bar. Stroke adjustment
Ball Valve : Body: AISI 316 and Cast iron, 2/2 or 3/2 way, flanged connection and ISO5211 standard actuator
Pressure : PN40,PN16
Temperature : -30..180°C
Size : NW15 ... NW200 Flange

Actuated Ball Valves, 2/2 Way, Monoblock

- Application** : Liquid, gas, air, water, hot water, steam
Natural gas, LPG Gas
- On Request** : Limit switch box, positioner, Namur solenoid valve, manual override
- Type No** : PAV 909.DA, PAV 909.SR
- Actuator** : RA..DA/SR rotary pneumatic actuator
Double / Single
- Supply Air** : 4-6 bar. Stroke adjustment
- Ball Valve** : Body: AISI 316 and Cast iron, 2/2 way
wafer type, flanged connection
and ISO5211 standard actuator
- Pressure** : PN40, PN16
- Temperature** : -30..180°C
- Size** : NW15 ... NW100 Flange



PAV 909 DA (Double Acting)
PAV 909 SR (Single Acting)

Actuated Ball Valves, , 2/2 Way, Monoblock, Cast Iron Body



PAV 910 DA (Double Acting)
PAV 910 SR (Single Acting)

- Application** : Liquid, gas, air, water, hot water, steam
Natural gas, LPG Gas
- On Request** : Limit switch box, positioner, Namur solenoid valve, manual override
- Type No** : PAV 910.DA, PAV 910.SR
- Actuator** : RA..DA/SR rotary pneumatic actuator
Double / Single
- Supply Air** : 4-6 bar. Stroke adjustment
- Ball Valve** : Body: Cast iron, 2/2 way
wafer type, flanged connection
and ISO5211 standard actuator
- Pressure** : PN40, PN16
- Temperature** : -30..180°C
- Size** : NW15 ... NW100 Flange

Actuated Ball Valve, 2/2 ve 3/2 Way, PVC Body

- Application** : Liquids, acid, water
- On Request** : Limit switch box, positioner, Namur solenoid valve, manual override
- Type No** : PAV 913.DA, PAV 913.SR
- Actuator** : RA..DA/SR rotary pneumatic actuator
Double / Single
- Supply Air** : 4-6 bar. Stroke adjustment
- Ball Valve** : Body: PP, 2/2 or 3/2 way
screwed or welding connection
and ISO5211 standard actuator
- Pressure** : PN40, PN16
- Temperature** : -10..80°C
- Size** : NW15 ... NW100



PAV 913.SR / PAV 913.DA

Actuated Ball Valve, Flanged / Screwed Connection 2/2 ve 3/2 Way, Cast Iron Body



PAV 907F.15 DA
PAV 907F.15 SR
2/2 Way



PAV 908F.15 DA
PAV 908F.15 SR
3/2 Way

- Application** : Liquid, gas, air, water, hot water, steam
Natural gas, LPG Gas
- On Request** : Limit switch box, positioner, Namur solenoid valve, manual override
- Type No** : **Flanged** PAV 907F.DA, PAV 907F.SR,
PAV 908F.DA, PAV 908F.SR
Screwed PAV 907S.DA, PAV 907S.SR,
PAV 908S.DA, PAV 908S.SR
- Actuator** : RA..DA/SR rotary pneumatic actuator Double / Single
- Supply Air** : 4-6 bar. Stroke adjustment
- Ball Valve** : Body: AISI 316 and Cast iron, 2/2 or
3/2 way, screwed / flanged connection
and ISO5211 standard actuator
- Pressure** : PN40, PN16
- Temperature** : -30..180°C
- Size** : NW15 ... NW200 Flange

Actuated Valves, 2/2 Way for Food Industry

- Application** : Liquid, Food industry, Hygienic
Natural gas, LPG Gas
- On Request** : Limit switch box, positioner, namur
solenoid valve, manual override
- Type No** : PAV 813.DA, PAV 813.SR
- Actuator** : RA..DA/SR rotary pneumatic actuator
Double / Single
- Supply Air** : 4-6 bar. Stroke adjustment
- Ball Valve** : Body: AISI 316 and Cast iron, 2/2 way,
and ISO5211 standard actuator
- Pressure** : PN16 / PN10
- Temperature** : -30..140°C
- Size** : NW15 ... NW100



PAV 813.DA (Double acting)
PAV 813.SR (Single acting)

Actuated Butterfly Valves, Wafer and Lug Types



PAV 800. DA Serie
PAV 800. SR Serie



PAV 801. DA Serie
PAV 801. SR Serie

- Application** : Liquid, gas, air, water, hot water, steam
Natural gas, LPG Gas
- On Request** : Limit switch box, positioner, Namur
solenoid valve, manual override
- Type No** : PAV 800.DA, PAV 800.SR,
PAV 801.DA, PAV 801.SR
- Actuator** : RA..DA/SR rotary pneumatic actuator Double / Single
- Supply Air** : 4-6 bar. Stroke adjustment
- Butterfly Valve** : Body: GG25 Epoxy or Rilsan coated, Disc: AISI 316
Butterfly type KVW121 and KVL 141,
ISO5211 standard actuator
- Pressure** : PN10, PN16
- Temperature** : -30..140°C, Seal: EPDM
- Size** : NW50 ... NW600

Actuated Butterfly Valves, Wafer and Lug Types for Industrial applications

- Application** : Liquid, gas, air, water, hot water, steam
Natural gas, LPG Gas
- On Request** : Limit switch box, positioner, Namur
solenoid valve, manual override
- Type No** : PAV 802.DA, PAV 802.SR,
PAV 803.DA, PAV 803.SR
- Actuator** : RA..DA/SR rotary pneumatic actuator Double / Single
- Supply Air** : 4-6 bar. Stroke adjustment
- Butterfly Valve** : Body: GG25 Epoxy or Rilsan coated, Disc: AISI 316
Butterfly type KVW 1140 and KVL 1120,
ISO5211 standard actuator
- Pressure** : PN10, PN16
- Temperature** : -30..140°C, Seal: EPDM or Viton or PTFE or Silicon
- Size** : NW25 ... NW800 Flange



PAV 802 DA Serie



PAV 803 DA Serie

Actuated Butterfly Valves, Lug Types



PVC Body butterfly valve



PAV 804 DA

- Application** : Liquids
- On Request** : Limit switch box, positioner, Namur
solenoid valve, manual override
- Type No** : PAV 804.DA, PAV 804.SR
- Actuator** : RA..DA/SR rotary pneumatic actuator Double / Single
- Supply Air** : 4-6 bar. Stroke adjustment
- Butterfly Valve** : Body: GG25 Epoxy / PP, Disc: AISI 316
ISO5211 standard actuator
- Pressure** : PN10, PN16
- Temperature** : -30..140°C, Seal: EPDM
- Size** : NW25 ... NW800 Flange

Actuated Butterfly Valves, Wafer / Lug Types - Teflon Seated

- Application** : Liquid, gas, air, water, hot water, steam
- On Request** : Limit switch box, positioner, Namur solenoid valve, manual override
- Type No** : PAV 805.DA, PAV 805.SR, PAV 806.DA, PAV 806.SR
- Actuator** : RA..DA/SR rotary pneumatic actuator Double / Single
- Supply Air** : 4-6 bar. Stroke adjustment
- Butterfly Valve** : Body: GG25 Rilsan coated or AISI316, Disc: AISI 316 ISO5211 standard actuator
- Pressure** : PN10, PN16
- Temperature** : -30..180°C, Seal: PTFE
- Size** : NW50 ... NW300 Flange

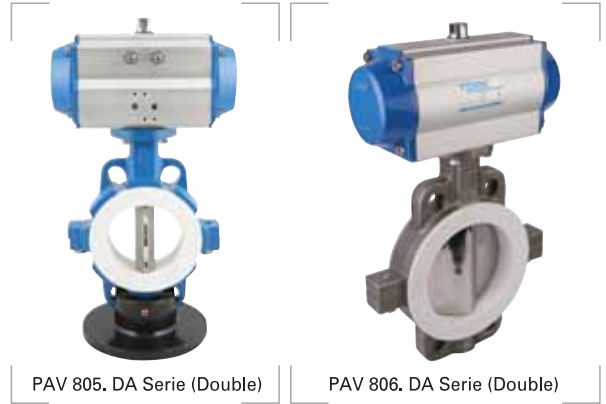

Actuated Ball Valve, 2/2 ve 3/2 Way, PVC Body



RAV 812.DA
RAV 812.SR

- Application** : Liquids, acid, water
- On Request** : Limit switch box, positioner, Namur solenoid valve, manual override
- Type No** : PAV 812.DA, PAV 812.SR
- Actuator** : RA..DA/SR rotary pneumatic actuator Double / Single
- Supply Air** : 4-6 bar. Stroke adjustment
- Ball Valve** : Body: PP, 2/2 or 3/2 way screwed or welding connection and ISO5211 standard actuator
- Pressure** : PN6, PN10
- Temperature** : -10..80°C
- Size** : NW15 ... NW100

Actuated Butterfly Valves, Wafer Flanged Types

- Application** : Liquid, gas, air, water, hot water, steam
- On Request** : Limit switch box, positioner, Namur solenoid valve, manual override
- Type No** : PAV 810.DA, PAV 810.SR,
- Actuator** : RA..DA/SR rotary pneumatic actuator Double / Single
- Supply Air** : 4-6 bar. Stroke adjustment
- Butterfly Valve** : Body: GG25 Epoxy or Rilsan coated, Disc: AISI 316 Butterfly type KVL 1150, KVL 1160, KVL 1170 ISO5211 standard actuator
- Pressure** : PN10, PN16
- Temperature** : -30..140°C, Seal: EPDM or Viton or PTFE or Silicon
- Size** : NW350 ... NW900 Flange



Ball Valve, Stainless Steel, Screwed Connection; Manual and ISO5211 Flanged type



- Ball Valve** : Body: AISI 316 Stainless steel, 2/2 or 3/2 way, screwed connection, ISO5211 standard actuator
- Pressure** : PN40, PN16
- Temperature** : -30..180 C
- Size** : 1/2" 2" screwed
- Control** : Manual override
ISO5211 Flanged actuator control
- T-KV903, 2/2 way screwed connection, ISO5211 Flanged
- T-KV903K, 2/2 way screwed connection, manual override
- T-KV904, 3/2 way screwed connection, ISO5211 Flanged
- T-KV904, 3/2 way screwed connection, manual override

Ball Valve, Brass Body, Screwed Connection; Manuel and ISO5211 Flanged type

Bal Valve : Body: Brass, 2/2 or 3/2 way, screwed connection, ISO5211 standard actuator

Pressure : PN40, PN16

Temperature : -30..180 C

Size : 1/2" 2" screwed

Control : Manual override
ISO5211 Flanged actuator control

T-KV901, 2/2 way screwed connection, ISO5211 Flanged
T-KV901K, 2/2 way screwed connection, manual override
T-KV902, 3/2 way screwed connection, ISO5211 Flanged
T-KV902, 3/2 way screwed connection, manual override



Butterfly Valve Wafer Type and Lug Type

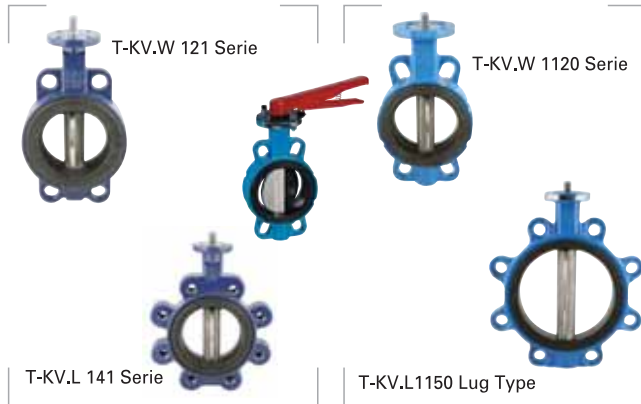

Butterfly Valve : Body: GG25 Epoxy or rilsan coated stainless steel ve ISO5211 standard actuator flange connection or interconnection

Body Type : Wafer tip, LUG tip

Disc : Stainless steel, on request: GG25 epoxy coated,

Rubber diaphragm : EPDM (-30...140°C),
on request: Viton, PTFE, Silicon

Pressure : PN6, on request: PN10, PN16

Temperature : -30..140°C

Size : NW25" NW600"

Seal Option : EPDM
T-KV.W121 serie wafer / T-KV.W141 serie lug type
EPDM, PTFE, VITON, NİTRİL
T-KV.W1120 Seri wafer / T-KV.W1150 sere lug type

Ball Valve, Monoblock, Cast Iron and Stainless Steel Body

T-KV 909 Stainless Monoblock Ball Valve
T-KV 910 Cast Iron Monoblock Ball Valve
T-KV 903F Stainless Steel Flanged Monoblock Ball Valve
T-KV 910F Flanged Monoblock Ball Valve

Body : Cast iron / Stainless steel

Sphere : Stainless steel

Pressure : PN16, PN40, PN63

Way : 2/2, 3/2

On request : Steam jacketed type

Size : NW15 ... NW100

Temperature : -20 °C ... 180°C

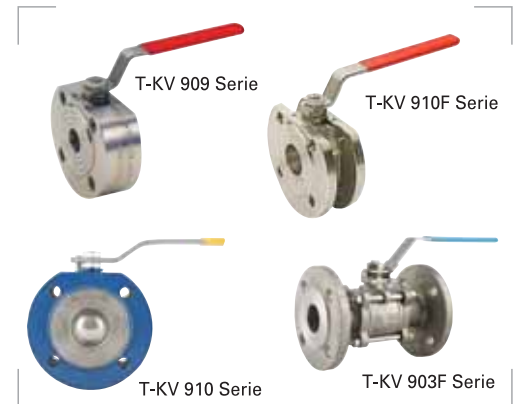

PVC Küresel Vanalar ve Hijyen Vanalar



T-PKV 912 PVC Ball Valve
T-HSV Stainless Steel Hygiene Valve
T-DKV 812 Diaphragm Valve
T-PKV 812 PVC Butterfly Valve

Size : NW15 ... NW100

Temperature : -20 °C...80°C

Pressure : PN10, PN 16

Application : Liquids, aggressive fluid types, food industry, particle fluid types

Why hydraulic actuator?

- > Small size
- > High torque value



Model SA-H

APPLICATION

- Ball valves
- Butterfly valves
- Dampers
- Other hydraulic systems

Working pressure : 100 bar/210 bar
 Working temperature : -10°C ... +75°C
 Valve mounting standard : DIN ISO 5211
 Turned angle : 90° ±1°

- On request :
- Mechanic limit switch
 - Proximity limit switch
 - Spring return pneumatic actuator

Hydraulic actuators and output torque

Actuator Type	100 bar control pressure, output torque value (Nm)	210 bar control pressure, output torque value (Nm)
SA - H 30	30 Nm	63 Nm
SA - H 42	90 Nm	200 Nm
SA - H 55	210 Nm	441 Nm
SA - H 63	300 Nm	630 Nm
SA - H 80	700 Nm	1512 Nm
SA - H 100	1450 Nm	3087 Nm
SA - H 125	2100 Nm	4620 Nm
SA - H 140	3000 Nm	6300 Nm



Application

Butterfly valve recommended at 100 bar for hydraulic actuators

Valve size NW	25 32 40	50 65 100 125	150 200	250	300 350 400	500	600
Actuator type	SA-H 30	SA-H 42	SA-H 55	SA-H 63	SA-H 80	SA-H 100	SA-H 125

Butterfly valve recommended at 220 bar for hydraulic actuators

Valve size NW	25, 32, 40, 50, 65, 80	100, 125, 150, 200	250	300	350, 400, 500	600
Actuator type	SA-H 30	SA-H 42	SA-H 55	SA-H 63	SA-H 80	SA-H 100

Contact us for different applications.

